

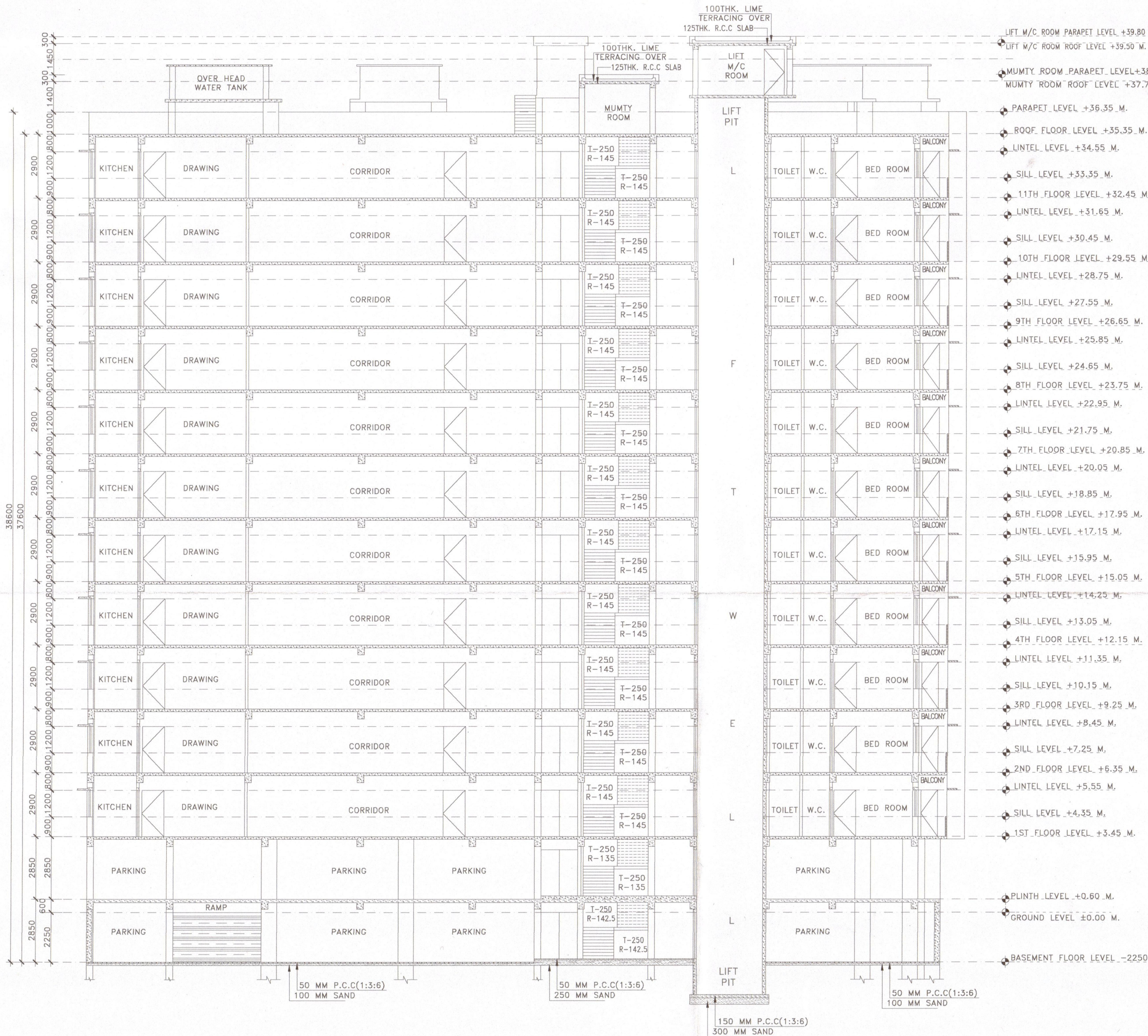

**(A) FRONT SIDE ELEVATION**  
SCALE: 1:100



**(B) SECTION: -X-X'**  
SCALE: 1:100

**PROJECT NAME:**  
PLAN OF PROPOSED (B+G+11) THIRTEEN STORED RESIDENTIAL CUM COMMERCIAL BUILDING OF MRS. SHOBHA GHOSH, W/O NARAYAN CHANDRA GHOSH, MR. ASHOK SINHA S/O NARAYAN SINHA, MRS. RINA GHOSH, W/O MUKTIPADA GHOSH, MRS. MANJU SINGH, W/O ALOK KUMAR SINGHA, MISS. DIPIKA MONDAL, D/O LATE HIMANGSU MONDAL, MR. SOURAV MONDAL, S/O LATE HIMANGSU MONDAL, MRS. REKHA MONDAL, W/O LATE HIMANGSU MONDAL, MRS. DALIYA BANERJEE, W/O SUPRABHAT BANERJEE, R.S PLOT NO- 65, 65/489, L. R PLOT NO-280,281,283,284,285,286, L.R. KHATIAN NO-1974,2151,2152,2925,2926,2927,1855,2182,530, J. L NO -109 MOUZA-SHANKARPUR, P. S - N.T.P.S, DIST-PASCHIM, BARDHAMAN, WEST BENGAL

**SCHEDULE OF DOOR & WINDOW:-**

MARK	SIZE	DESCRIPTION
D1	1000X2100	FULLY PNL
D2	900X2100	FULLY PNL
D3	750X2100	FULLY PNL
W	1800X1200	SLIDING WINDOW
W1	1500X1200	SLIDING WINDOW
W2	1200X1200	SLIDING WINDOW
W3	1000X1200	SLIDING WINDOW
W4	900X1200	SLIDING WINDOW
V.V2		VENTILATION FOR STAIR CASE
V4	600X450	UPVC MOVABLE VENTILATOR

- \*\*\* NOTES :-**
- ALL DIMENSIONS ARE IN M.M., ROAD IS IN FT. & INCH. AND ALL LEVEL ARE IN M.
  - WRITTEN DIMENSIONS MUST BE FOLLOWED.
  - ALL EXTERNAL WALLS 250TH. & INTERNAL WALLS 125THK. UNLESS OTHERWISE MENTIONED.
  - ALL MASONRY WORKS ARE BOUNDED BY CEMENT MORTAR (1:6) & (1:4).
  - EXTERNAL PLASTER IS 25THK. & INTERNAL PLASTER IS 12MM.THK.
  - ALL CONC. GRADE IS M25 & AND GRADE OF STEEL FE-500.
  - 250THK. BRICK WORK IN 1:6 MORTAR.
  - 125THK. & 75THK. BRICK WORK IN 1:4 MORTAR.
  - 150 WIDE SURFACE DRAIN SHOULD BE PROVIDED ALL ROUND THE BUILDING.
  - 25% OF THE BUILDING TO BE CONSTRUCTED USING FLY-ASH BRICKS.

**AREA CALCULATION:-**

LAND AREA	PLINTH AREA	
	BASTMENT FLOOR	1240.13 SQ.M.
	GROUND FLOOR	1168.83 SQ.M.
	FIRST FLOOR	1113.23 SQ.M.
	SECOND FLOOR	1113.23 SQ.M.
	THIRD FLOOR	1109.31 SQ.M.
	FORTH FLOOR	1109.31 SQ.M.
	FIFTH FLOOR	1109.31 SQ.M.
	SIXTH FLOOR	1109.31 SQ.M.
	SEVENTH FLOOR	1109.31 SQ.M.
	EIGHTH FLOOR	1109.31 SQ.M.
	NINTH FLOOR	1109.31 SQ.M.
	TENTH FLOOR	1109.31 SQ.M.
	ELEVENTH FLOOR	1109.31 SQ.M.
	<b>TOTAL</b>	<b>14619.21 SQ.M.</b>

\* GROUND COVERAGE = 44.43%  
\* F.A.R = 2.49

**SIGNATURE OF DEVELOPER/OWNER:-**  
Ashok Sinha  
Rina Ghosh  
Daliya Banerjee  
Rekha Mondal  
Sourav Mondal

**SIGNATURE OF ARCHITECT :-**  
Manju Monowara Khatun  
MANJU MONOWARA KHATUN  
ARCHITECT  
CA/2022/148222  
G.I.D.S., Durgapur-16

**SIGNATURE OF GEO TECHNICAL ENGINEER:-**  
Manju Monowara Khatun  
Civil & Geotechnical Engineer  
CE. No. 14/273  
Lic. No. - LBP/14/273/AMC  
G.I.D.S., Durgapur-16

**SIGNATURE OF STRUCTURAL ENGINEER:-**  
Hirsh Ghosh  
Structural Engineer  
Lic. No. L.B.P/14/14/AMC  
DCE, B-TECH, G.I.D.S., Durgapur-16  
Contact No. - 780284197

**TITLE:**  
\* FRONT SIDE ELEVATION  
\* SECTIONAL VIEW

DRAWN BY: S.PANJA, P.DEY.  
CHECKED BY: M.KHATUN  
SCALE: 1:100  
REV-00 DATE:22.08.2022  
SHEET NO:- ARCH./P&R-01/08